

## TECHNICAL CARD

**PRODUCT NAME** : Pintle Ø 18 to L-800  
embedded

**ITEM CODE** : 40.009

**TECHNICAL DATA** : Material – Steel S235JR  
Weight of 1 pc – 0,46 kg  
Coating – anticorrosive applied  
by cataphoresis  
method  
Colour – black

**APPLICATION** : Pintle is used to fitting  
wicket/fence and garage gates.

**PRODUCER** : Komet company – Polish  
producer of construction  
hardware for gates.

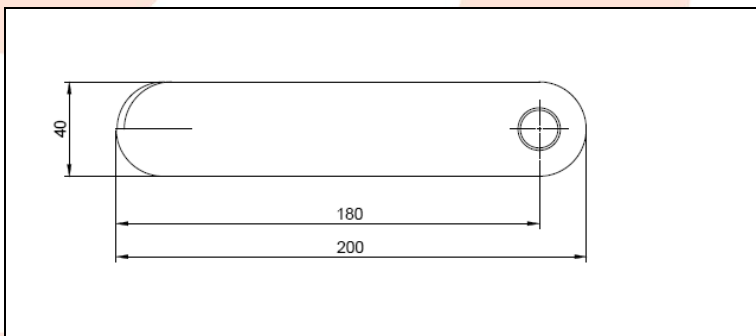
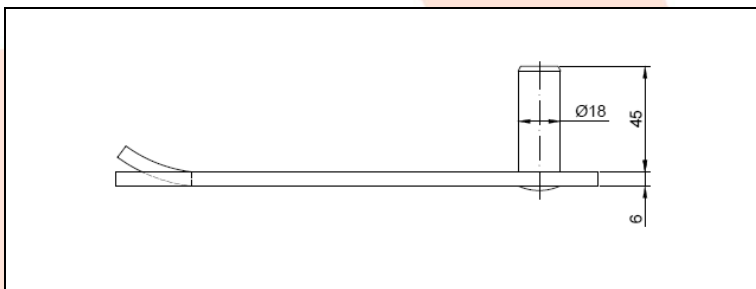
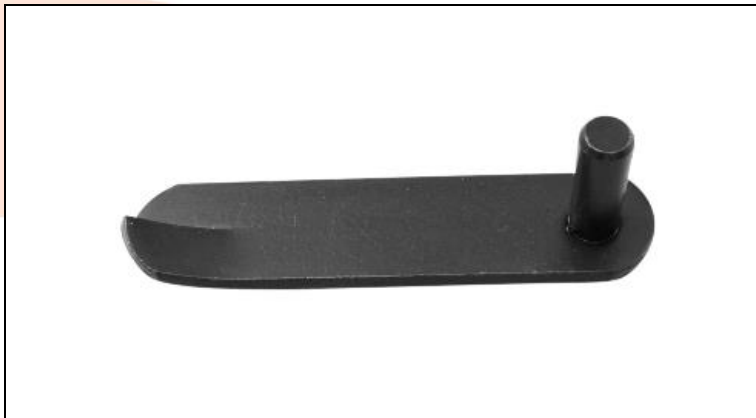

**NOTES** : All technical data are approximate values. The manufacturer reserves the right to correct the product and change the technical conditions with the possibility of making changes inside the specification. This information cannot be considered as a guarantee, nor is it legally binding in any way.