

TECHNICAL CARD

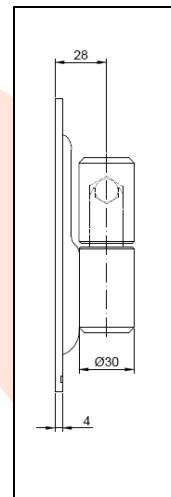
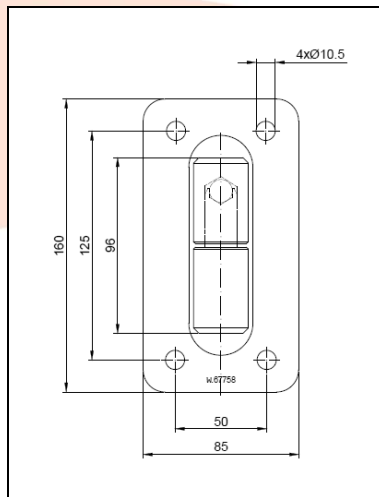

PRODUCT NAME : Hinge Ø 30 screwed

ITEM CODE : 40.003

TECHNICAL DATA : Material – S235JR steel
Weight of 1 pc – 0.93 kg
Coating – base - galvanic zinc / sleeve - scale-free, shot blasting
Color – base - white zinc / sleeve - steel

APPLICATION : Hinge is used to fitting wicket/fence and garage gate.

PRODUCER : Komet company – Polish producer of construction hardware for gates.

INNOVATION : Product protected by patent low W.67758

NOTES : All technical data are approximate values. The manufacturer reserves the right to correct the product and change the technical conditions with the possibility of making changes inside the specification. This information cannot be considered as a guarantee, nor is it legally binding in any way.